

INDUSTRICAL PLUG



Type: P1134
 Earth: 4h
 Current: 16A
 Voltage: 100-130V~
 Pole: 2P+E



IP44 Splashproof



Type: P1234
 Earth: 6h
 Current: 16A
 Voltage: 200-250V~
 Pole: 2P+E



IP44 Splashproof



Type: P3134
 Earth: 4h
 Current: 32A
 Voltage: 100-130V~
 Pole: 2P+E



IP44 Splashproof



Type: P3234
 Earth: 6h
 Current: 32A
 Voltage: 200-250V~
 Pole: 2P+E



IP44 Splashproof



| | | |
|----------|--------|--------|
| Type: | P11341 | P31341 |
| Current: | 16A | 32A |

Earth: 4h
 Voltage: 100-130V~
 Pole: 2P+E



IP44 Splashproof



| | | |
|----------|--------|--------|
| Type: | P12341 | P32341 |
| Current: | 16A | 32A |

Earth: 6h
 Voltage: 200-250V~
 Pole: 2P+E



IP44 Splashproof



| | | |
|----------|--------|--------|
| Type: | P12441 | P32441 |
| Current: | 16A | 32A |

Earth: 9h
 Voltage: 200-250V~
 Pole: 3P+E



IP44 Splashproof

INDUSTRIAL PLUG



| | | |
|----------|-----------|--------|
| Type: | P14441 | P34441 |
| Current: | 16A | 32A |
| Earth: | 6h | |
| Voltage: | 380-415V~ | |
| Pole: | 3P+E | |



IP44 Splashproof



| | | |
|----------|-------------------|--------|
| Type: | P14541 | P34541 |
| Current: | 16A | 32A |
| Earth: | 6h | |
| Voltage: | 220/380-240/415V~ | |
| Pole: | 3P+N+E | |



IP44 Splashproof



| | | |
|----------|-----------|----------|
| Type: | P14441-D | P34441-D |
| Current: | 16A | 32A |
| Earth: | 6h | |
| Voltage: | 380-415V~ | |
| Pole: | 3P+E | |



IP44 Splashproof



| | | |
|----------|-------------------|----------|
| Type: | P14541-D | P34541-D |
| Current: | 16A | 32A |
| Earth: | 6h | |
| Voltage: | 220/380-240/415V~ | |
| Pole: | 3P+N+E | |



IP44 Splashproof



| | | |
|----------|-----------|-------|
| Type: | P1136 | P3136 |
| Current: | 16A | 32A |
| Earth: | 4h | |
| Voltage: | 100-130V~ | |
| Pole: | 2P+E | |



IP67 Splashproof



| | | |
|----------|-----------|-------|
| Type: | P1236 | P3236 |
| Current: | 16A | 32A |
| Earth: | 6h | |
| Voltage: | 200-250V~ | |
| Pole: | 2P+E | |



IP67 Splashproof



| | | |
|----------|-----------|-------|
| Type: | P1446 | P3446 |
| Current: | 16A | 32A |
| Earth: | 6h | |
| Voltage: | 380-415V~ | |
| Pole: | 3P+E | |



IP67 Splashproof



| | | |
|----------|-------------------|-------|
| Type: | P1456 | P3456 |
| Current: | 16A | 32A |
| Earth: | 6h | |
| Voltage: | 220/380-240/415V~ | |
| Pole: | 3P+N+E | |



IP67 Splashproof

INDUSTRIAL PLUG



Type:

| | |
|---------|---------|
| FP11341 | FP31341 |
|---------|---------|

 Current:

| | |
|-----|-----|
| 16A | 32A |
|-----|-----|

 Earth: **4h**
 Voltage: 100-130V~
 Pole: 2P+E

IP44 Splashproof



Type:

| | |
|---------|---------|
| FP12341 | FP32341 |
|---------|---------|

 Current:

| | |
|-----|-----|
| 16A | 32A |
|-----|-----|

 Earth: **6h**
 Voltage: 200-250V~
 Pole: 2P+E

IP44 Splashproof



Type:

| | |
|---------|---------|
| FP14441 | FP34441 |
|---------|---------|

 Current:

| | |
|-----|-----|
| 16A | 32A |
|-----|-----|

 Earth: **6h**
 Voltage: 380-415V~
 Pole: 3P+E

IP44 Splashproof



Type:

| | |
|---------|---------|
| FP14541 | FP34541 |
|---------|---------|

 Current:

| | |
|-----|-----|
| 16A | 32A |
|-----|-----|

 Earth: **6h**
 Voltage: 220/380-240/415V~
 Pole: 3P+N+E

IP44 Splashproof



Type:

| | |
|---------|---------|
| MP11341 | MP31341 |
|---------|---------|

 Current:

| | |
|-----|-----|
| 16A | 32A |
|-----|-----|

 Earth: **4h**
 Voltage: 100-130V~
 Pole: 2P+E

IP44 Splashproof



Type:

| | |
|---------|---------|
| MP12341 | MP32341 |
|---------|---------|

 Current:

| | |
|-----|-----|
| 16A | 32A |
|-----|-----|

 Earth: **6h**
 Voltage: 200-250V~
 Pole: 2P+E

IP44 Splashproof



Type:

| | |
|---------|---------|
| MP14441 | MP34441 |
|---------|---------|

 Current:

| | |
|-----|-----|
| 16A | 32A |
|-----|-----|

 Earth: **6h**
 Voltage: 380-415V~
 Pole: 3P+E

IP44 Splashproof



Type:

| | |
|---------|---------|
| MP14541 | MP34541 |
|---------|---------|

 Current:

| | |
|-----|-----|
| 16A | 32A |
|-----|-----|

 Earth: **6h**
 Voltage: 220/380-240/415V~
 Pole: 3P+N+E

IP44 Splashproof

INDUSTRIAL SOCKET



| | | |
|----------|-----------|--------|
| Type: | FS1134 | FS3134 |
| Current: | 16A | 32A |
| Earth: | 4h | |
| Voltage: | 100-130V~ | |
| Pole: | 2P+E | |

IP44 Splashproof



| | | |
|----------|-----------|--------|
| Type: | FS1234 | FS3234 |
| Current: | 16A | 32A |
| Earth: | 6h | |
| Voltage: | 200-250V~ | |
| Pole: | 2P+E | |

IP44 Splashproof



| | | |
|----------|-----------|---------|
| Type: | FS11341 | FS31341 |
| Current: | 16A | 32A |
| Earth: | 4h | |
| Voltage: | 100-130V~ | |
| Pole: | 2P+E | |

IP44 Splashproof



| | | |
|----------|-----------|---------|
| Type: | FS12341 | FS32341 |
| Current: | 16A | 32A |
| Earth: | 6h | |
| Voltage: | 200-250V~ | |
| Pole: | 2P+E | |

IP44 Splashproof



| | | |
|----------|-----------|---------|
| Type: | FS14441 | FS34441 |
| Current: | 16A | 32A |
| Earth: | 6h | |
| Voltage: | 380-415V~ | |
| Pole: | 3P+E | |

IP44 Splashproof



| | | |
|----------|-------------------|---------|
| Type: | FS14541 | FS34541 |
| Current: | 16A | 32A |
| Earth: | 6h | |
| Voltage: | 220/380-240/415V~ | |
| Pole: | 3P+N+E | |

IP44 Splashproof



| | | |
|----------|-----------|--------|
| Type: | FS1136 | FS3136 |
| Current: | 16A | 32A |
| Earth: | 4h | |
| Voltage: | 100-130V~ | |
| Pole: | 2P+E | |

IP67 Splashproof



| | | |
|----------|-----------|--------|
| Type: | FS1236 | FS3236 |
| Current: | 16A | 32A |
| Earth: | 6h | |
| Voltage: | 200-250V~ | |
| Pole: | 2P+E | |

IP67 Splashproof

INDUSTRIAL SOCKET



CE

| | | |
|----------|-----------|--------|
| Type: | FS1446 | FS3446 |
| Current: | 16A | 32A |
| Earth: | 6h | |
| Voltage: | 380-415V~ | |
| Pole: | 3P+E | |

IP67 Splashproof



CE

| | | |
|----------|-------------------|--------|
| Type: | FS1456 | FS3456 |
| Current: | 16A | 32A |
| Earth: | 6h | |
| Voltage: | 220/380-240/415V~ | |
| Pole: | 3P+N+E | |

IP67 Splashproof



CE S

| | | |
|----------|-----------|--------|
| Type: | M11341 | M31341 |
| Current: | 16A | 32A |
| Earth: | 4h | |
| Voltage: | 100-130V~ | |
| Pole: | 2P+E | |

IP44 Splashproof



CE S

| | | |
|----------|-----------|--------|
| Type: | M12341 | M32341 |
| Current: | 16A | 32A |
| Earth: | 6h | |
| Voltage: | 200-250V~ | |
| Pole: | 2P+E | |

IP44 Splashproof



CE S

| | | |
|----------|-----------|--------|
| Type: | M14441 | M34441 |
| Current: | 16A | 32A |
| Earth: | 6h | |
| Voltage: | 380-415V~ | |
| Pole: | 3P+E | |

IP44 Splashproof



CE S

| | | |
|----------|-------------------|--------|
| Type: | M14541 | M34541 |
| Current: | 16A | 32A |
| Earth: | 6h | |
| Voltage: | 220/380-240/415V~ | |
| Pole: | 3P+N+E | |

IP44 Splashproof

INDUSTRIAL COUPLER



Type: S1134
 Earth: 4h
 Current: 16A
 Voltage: 100-130V~
 Pole: 2P+E



IP44 Splashproof



Type: S1234
 Earth: 6h
 Current: 16A
 Voltage: 200-250V~
 Pole: 2P+E



IP44 Splashproof



Type: S3134
 Earth: 4h
 Current: 32A
 Voltage: 100-130V~
 Pole: 2P+E



IP44 Splashproof



Type: S3234
 Earth: 6h
 Current: 32A
 Voltage: 200-250V~
 Pole: 2P+E



IP44 Splashproof



Type:

| | |
|--------|--------|
| S11341 | S31341 |
|--------|--------|

 Current:

| | |
|-----|-----|
| 16A | 32A |
|-----|-----|

 Earth: 4h
 Voltage: 100-130V~
 Pole: 2P+E



IP44 Splashproof



Type:

| | |
|--------|--------|
| S12341 | S32341 |
|--------|--------|

 Current:

| | |
|-----|-----|
| 16A | 32A |
|-----|-----|

 Earth: 6h
 Voltage: 200-250V~
 Pole: 2P+E



IP44 Splashproof



Type:

| | |
|--------|--------|
| S12441 | S32441 |
|--------|--------|

 Current:

| | |
|-----|-----|
| 16A | 32A |
|-----|-----|

 Earth: 9h
 Voltage: 380-415V~
 Pole: 3P+E



IP44 Splashproof

INDUSTRIAL COUPLER



Type:

| | |
|--------|--------|
| S14441 | S34441 |
|--------|--------|

Current:

| | |
|-----|-----|
| 16A | 32A |
|-----|-----|

Earth: **6h**
Voltage: 380-415V~
Pole: 3P+E



IP44 Splashproof



Type:

| | |
|--------|--------|
| S14541 | S34541 |
|--------|--------|

Current:

| | |
|-----|-----|
| 16A | 32A |
|-----|-----|

Earth: **6h**
Voltage: 220/380-240/415V~
Pole: 3P+N+E



IP44 Splashproof



Type:

| | |
|-------|-------|
| S1136 | S3136 |
|-------|-------|

Current:

| | |
|-----|-----|
| 16A | 32A |
|-----|-----|

Earth: **4h**
Voltage: 100-130V~
Pole: 2P+E



IP67 Splashproof



Type:

| | |
|-------|-------|
| S1236 | S3236 |
|-------|-------|

Current:

| | |
|-----|-----|
| 16A | 32A |
|-----|-----|

Earth: **6h**
Voltage: 200-250V~
Pole: 2P+E



IP67 Splashproof



Type:

| | |
|-------|-------|
| S1446 | S3446 |
|-------|-------|

Current:

| | |
|-----|-----|
| 16A | 32A |
|-----|-----|

Earth: **6h**
Voltage: 380-415V~
Pole: 3P+E



IP67 Splashproof



Type:

| | |
|-------|-------|
| S1456 | S3456 |
|-------|-------|

Current:

| | |
|-----|-----|
| 16A | 32A |
|-----|-----|

Earth: **6h**
Voltage: 220/380-240/415V~
Pole: 3P+N+E



IP67 Splashproof

EURO SOCKET



Type: Z134D
Current: 16A
Voltage: 250V~
Country: Germany



IP54 Splashproof



Type: P901
Current: 16A
Voltage: 250V~
Country: Germany



IP54 Splashproof



Type: Z134F
Current: 16A
Voltage: 250V~
Country: France



IP54 Splashproof



Type: Z134E
Current: 13A
Voltage: 250V~
Country: Britain



IP54 Splashproof



Type: Z134K
Current: 16A
Voltage: 250V~
Country: Denmark



IP54 Splashproof



Type: Z134S
Current: 10A
Voltage: 250V~
Country: Switzerland



IP54 Splashproof



Type: Z134A
Current: 15A
Voltage: 250V~
Country: Australia

SAA-151895-EA

IP54 Splashproof



Type: Z134A-1
Current: 10A
Voltage: 250V~
Country: Australia

SAA-151895-EA

IP54 Splashproof

ADAPTOR SOCKET



Typ: T01F
16A250V~
Plug: 16A-6h,2P+E
Socket: S1234
Standard: EN50250
IP20



Typ: T02E
13A250V~
1 Britain plug:13A250V~
1 CEE Socket: S1234
Standard: EN50250
IP20



Typ: G01D
16A250V~
Plug: 16A-6h,2P+E
Socket: Z134D
Standard: EN50250
IP44



Typ: G01F
16A250V~
Plug: 16A-6h,2P+E
Socket: Z134F
Standard: EN50250
IP44

ADAPTOR SOCKET



Typ: G01P
16A250V~
Plug: 16A-6h,2P+E
Socket: P901
Standard: EN50250
IP44



Typ: G01E
13A250V~
Plug: 16A-6h,2P+E
Socket: Z134E
Standard: EN50250
IP44



Typ: G01K
16A250V~
Plug: 16A-6h,2P+E
Socket: Z134K
Standard: EN50250
IP44



Typ: G01A
15A250V~
Plug: 16A-6h,2P+E
Socket: Z134A
Standard: EN50250
IP44

ADAPTOR SOCKET



Typ: G01S
10A250V~
Plug: 16A-6h,2P+E
Socket: Z134S
Standard: EN50250
IP44



Typ: GX01E
1 CEE Plug(P1234):16A-6h,2P+E
1 UK Socket : 13A 250V~
1 Cable: H05VV-F 3G1.0/1.5,0.35M
Standard: EN60309/BS1363
IP20



Typ: GX01F
1 CEE Plug(P1234):16A-6h,2P+E
1 France Socket : 16A 250V~
1 Cable: H05VV-F 3G1.0/1.5,0.35M
Standard: EN60309/NF C61-314
IP20



Typ: GX01P
1 CEE Plug(P1234):16A-6h,2P+E
1 Germany Socket : 16A 250V~
1 Cable: H05VV-F 3G1.0/1.5,0.35M
Standard: EN60309/VDE0620
IP44

ADAPTOR SOCKET



Typ: TX02E
1 UK Plug: 13A 250V~
1 CEE Socket : 16A 2P+E
1 Cable: H05VV-F 3G1.0/1.5,0.35M

Standard: EN60309/BS1363
IP20



Typ: TX02F
1 France Plug: 16A 250V~
1 CEE Socket : 16A 2P+E
1 Cable: H05VV-F 3G1.0/1.5,0.35M

Standard: EN60309/VDE0620
IP44



Typ: OHQ1134
16A-4h/100-130V~,
2P+E, IP44
Standard: EN60309



Typ: OHQ1234
16A-6h/200-250V~,
2P+E, IP44
Standard: EN60309

ADAPTOR SOCKET



Typ: OHQ1134Y
16A-4h/100-130V~,
2P+E, IP44
Standard: EN60309



Typ: OHQ1234Y
16A-6h/200-250V~,
2P+E, IP44
Standard: EN60309



Typ: Q401
16A250V~
1 CEE Socket
1 Germany Socket
Standard: EN60309/VDE0620
IP44

CEE EXTENSION LEAD



Typ: Y01
1 CEE Plug(P1134):16A-4h,2P+E
1 CEE Coupler(S1134): 16A-4h,2P+E
1 Cable:H05VV-F 3G1.5/2.5
Standard: EN60309
IP44



Typ: Y02
1 CEE Plug(P11341):16A-4h,2P+E
1 CEE Coupler(S11341): 16A-4h,2P+E
1 Cable:H05VV-F 3G1.5/2.5
Standard: EN60309
IP44



Typ: Y03
1 CEE Plug(P1234):16A-6h,2P+E
1 CEE Coupler(S1234): 16A-6h,2P+E
1 Cable:H05VV-F 3G1.5/2.5
H05RR-F 3G1.5/2.5
H07RN-F 3G1.5/2.5
Standard: EN60309
IP44



Typ: Y04
1 CEE Plug(P12341):16A-6h,2P+E
1 CEE Coupler (S12341): 16A-6h,2P+E
1 Cable:H05VV-F 3G1.5/2.5
H05RR-F 3G1.5/2.5
H07RN-F 3G1.5/2.5
Standard: EN60309
IP44

CEE EXTENSION LEAD



Typ: Y05
1 CEE Plug(P14441):16A-6h,3P+E
1 CEE Coupler (S14441): 16A-6h,3P+E
1 Cable: H05RR-F 4G1.5/2.5
H07RN-F 4G1.5/2.5
Standard: EN60309
IP44



Typ: Y06
1 CEE Plug(P14541):16A-6h,3P+N+E
1 CEE Coupler (S14541): 16A-6h,3P+N+E
1 Cable: H05RR-F 5G1.5/2.5
H07RN-F 5G1.5/2.5
Standard: EN60309
IP44

CEE EXTENSION LEAD



Typ: J301
1 CEE Plug(P1134):16A-4h,2P+E
4 CEE Socket (FS1134): 16A-4h,2P+E
1 Cable: H05VV-F 3G1.5/2.5,3M
H07RN-F 3G1.5/2.5,3M
Standard: EN60309
IP44



Typ: J301-U
1 CEE Plug(P1134):16A-4h,2P+E
4 CEE Socket (FS1134): 16A-4h,2P+E
1 Cable: H05VV-F 3G1.5/2.5,3M
H07RN-F 3G1.5/2.5,3M
2 Port USB: 5V2.1A
Standard: EN60309
IP44

ELETRICAL SOCKET



Typ: P1234/TB01
1 CEE PLUG(P1234)
3 EURO SOCKET
1 Cable: H07RN-F 3G1.5/2.5
H05VV-F 3G1.5/2.5

IP44



Typ: P1234/TB02
1 CEE PLUG(P1234)
4 EURO SOCKET
1 Cable: H07RN-F 3G1.5/2.5
H05VV-F 3G1.5/2.5

IP44



Typ: P1234/TB03
1 CEE PLUG(P1234)
3 EURO SOCKET
1 Cable: H07RN-F 3G1.5/2.5
H05VV-F 3G1.5/2.5

IP44



Typ: P1234/TB01U
1 CEE PLUG(P1234)
3 EURO SOCKET
1 Cable: H07RN-F 3G1.5/2.5
H05VV-F 3G1.5/2.5
2 PORT USB
USB INPUT:100-240V~
USB OUTPUT: 5V2.1A
IP44



Typ: P1234/TB02U
1 CEE PLUG(P1234)
4 EURO SOCKET
1 Cable: H07RN-F 3G1.5/2.5
H05VV-F 3G1.5/2.5
2 PORT USB
USB INPUT: 100-240V~
USB OUTPUT: 5V2.1A
IP44



Typ: P1234/TB03U
1 CEE PLUG(P1234)
3 EURO SOCKET
1 Cable: H07RN-F 3G1.5/2.5
H05VV-F 3G1.5/2.5
2 PORT USB
USB INPUT: 100-240V~
USB OUTPUT: 5V2.1A
IP44

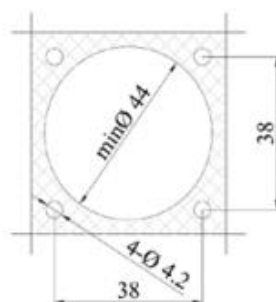
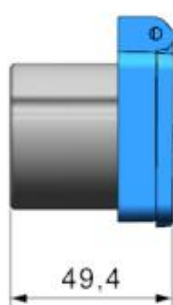
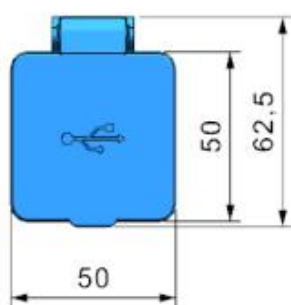

Input voltage: 100-250V~

Output voltage: 5V

Output current: 1A-----typ U1

Protect c 2.1A----typ U2

Function: use to mount on electrical unit,socket box, home appliance,
lamp and so on,you install it and itworks right away.



Typ: Y01L
1 CEE Plug with led:16A-4h,2P+E
1 CEE Coupler with led: 16A-4h,2P+E
1 Cable:H05VV-F 3G1.5/2.5
Standard: EN60309
IP44



Typ: Y03L
1 CEE Plug with led:16A-6h,2P+E
1 CEE Coupler with led: 16A-6h,2P+E
1 Cable:H05VV-F 3G1.5/2.5
H05RR-F 3G1.5/2.5
H07RN-F 3G1.5/2.5
Standard: EN60309
IP44



Typ: P1134 with led
16A-4h/100-130V~
2P+E, IP44
EN60309



Typ: P1234 with led
16A-6h/200-250V~
2P+E, IP44
EN60309



Typ: S1134 with led
16A-4h/100-130V~
2P+E, IP44
EN60309



Typ: S1234 with led
16A-6h/200-250V~
2P+E, IP44
EN60309

